

Connect power supply



Connect provided adapter



Output to Speakers, Recording, Video Conference, etc.



Output volume control: Should be turned up full for Line Level

Balance of volume between internal speakers and output: should be set fully to 'PA'

Float mode on/off: When maximum of 3 units are in use the 4th unit will 'take over' from the 1st.

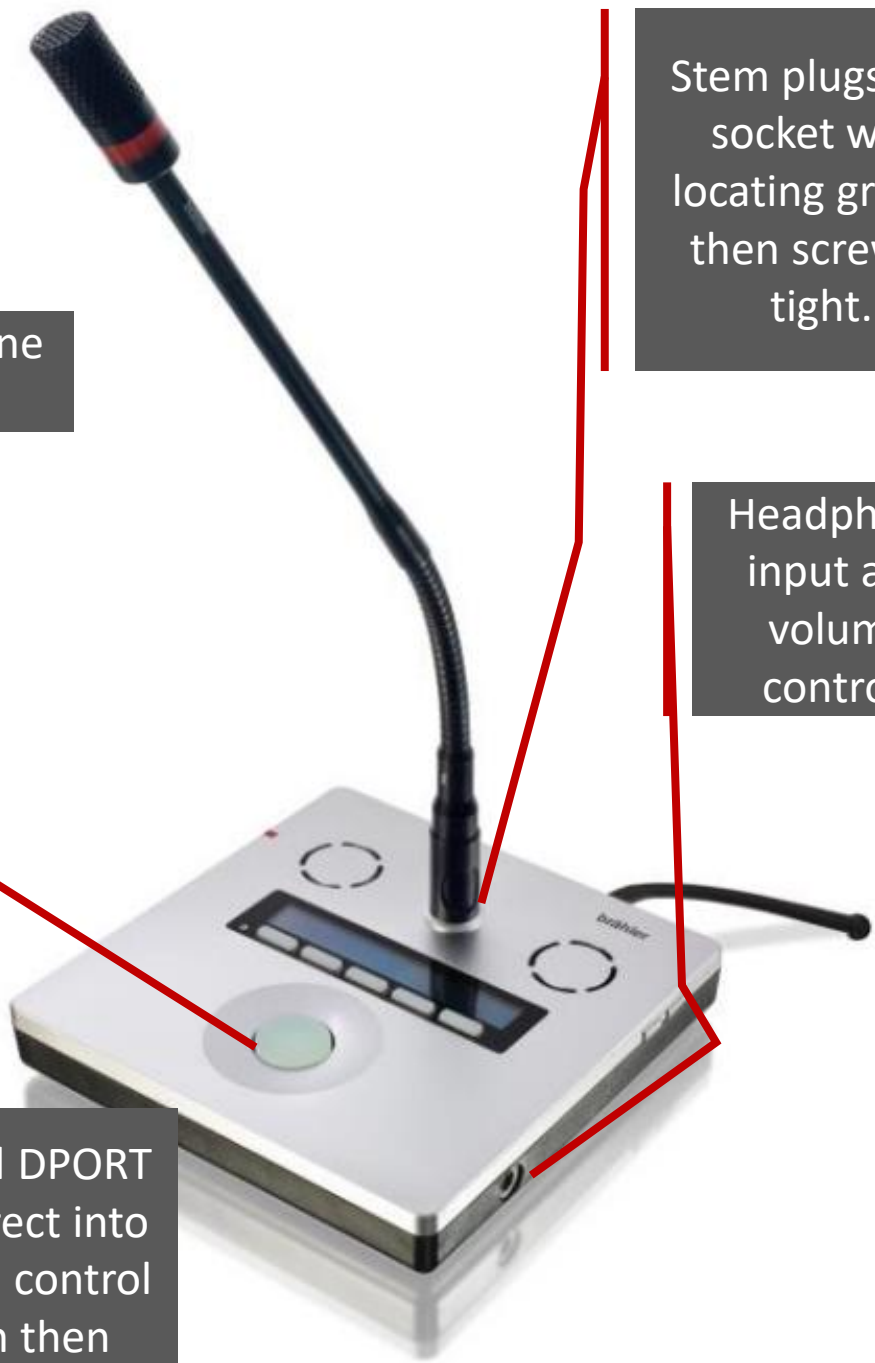

Stem plugs into socket with locating groove then screwed tight.

Microphone on/off

Headphone input and volume controls

The connected DPORT cable plugs direct into the DCEN Mini control unit. You can then daisy-chain up to 25 additional units.

